

## ECHO STRATA SINK MIXER

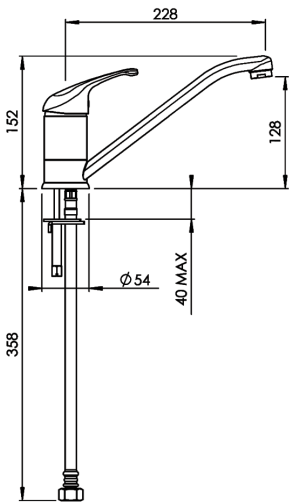

**CONSTRUCTION:** Brass body

**CARTRIDGE TYPE:** Ceramic

**CLASSIFICATION:** Suitable for **all pressures**

**INLET CONNECTIONS:** 1/2" BSP

**WORKING PRESSURE:** 35 - 500kPa

**DIMENSIONS FOR FITTING:** 35mm diameter hole

**OPERATING TEMPERATURE:** 5 °C - 65 °C

- Stainless steel flexible hoses for installation
- Fitted with aerator
- O-ring seal base on hose
- Includes a twin stud mounting kit
- 4 star WELS rated on mains pressure (7.5 l/pm)
- 4 star WELS rated on low pressure (7.5 l/pm)
- NEW handle design

E8214

Chrome

<http://www.methven.com/nz/our-other-brands/echo/echo-strata-sink-mixer-all-pressures>