

## Troubleshooting:

Description	Cause	Treatment
No water	The battery is flat Water supply Water supply blocked Water pressure too low	Change the battery Check the supply Check the inline filter Increase the water pressure
Water will not turn off	Dirty sensor window	Clean the sensor window
Insufficient flow	Water supply pressure is adjusted too low. Inline filter is blocked	Check the supply Check the inline filter
Too much water	Water supply adjusted too high.	Adjust the supply
Short battery life	Incorrect battery	Use 4 x AA / IEC-LR6 1.5V
Indicator light off	Light broken Circuit board or signal line wet The battery is flat Poor battery connection	Change the light or circuit board Dry the board Replace batteries Check the connection

# Sensor Basin Tap Installation Guide

## Technical Specifications:

### Operating Pressure:

Min: 150kPa/1.5bar  
Max: 700kPa/7bar\*  
Optimum: 250kPa/2.5bar

### Operating Temperature:

Hot: Max 55°C\*  
Cold: Min 5°C  
Recommended: 38°C

### Inlet Connection:

½" BSP female

### Power:

DC: 6V (4 AA alkaline batteries)  
AC: 220V - 240V; 50/60Hz  
Sensing Distance: 270 - 310mm

\* Regional specific regulations apply.  
Please refer to your warranty statement  
at [www.methven.com](http://www.methven.com)

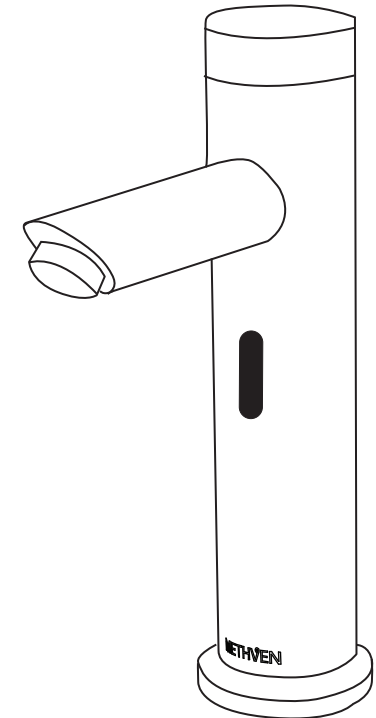

Methven warrants this product against manufacturing defects and that it is suitable for use under the general operating conditions specified in this instruction sheet. However, regional regulations apply and may affect your warranty. Please refer to [www.methven.com](http://www.methven.com) or call customer service for full details.

New Zealand  
0800 804 222

Australia  
1300 638 483

UK  
0800 195 1602

430002

ISSUE A

**METHVEN**  
[www.methven.com](http://www.methven.com)

**IMPORTANT:** Please read all of the instructions before installation.

**General:**

- Methven recommends this product is installed by a licensed plumber in compliance with all relevant regional regulations.
- Do not hydrostatic test the installation with this mixer installed. Damage to the mechanism may occur.
- All pipe work must be thoroughly flushed prior to the installation of the mixer.
- In-line filters must be fitted on both hot and cold supplies to prevent foreign particles damaging the mechanism.
- Do not install in direct sunlight.
- After installation all connections must be checked for leaks.
- All outlets used primarily for personal hygiene shall deliver water at a safe temperature as per regional regulations.
- This mixer is not recommended for use in uncontrolled heating systems such as wet-backs or solar heating units unless a suitable tempering valve is fitted.
- If limited water flow is experienced, locate aerator and filter washers and clean away foreign material as required.
- It is the responsibility of the installer to ensure a waterproof seal is achieved between the product and mounting surface. If in doubt about the quality of the seal, remove the product and reinstall using silicone to ensure a seal is achieved.

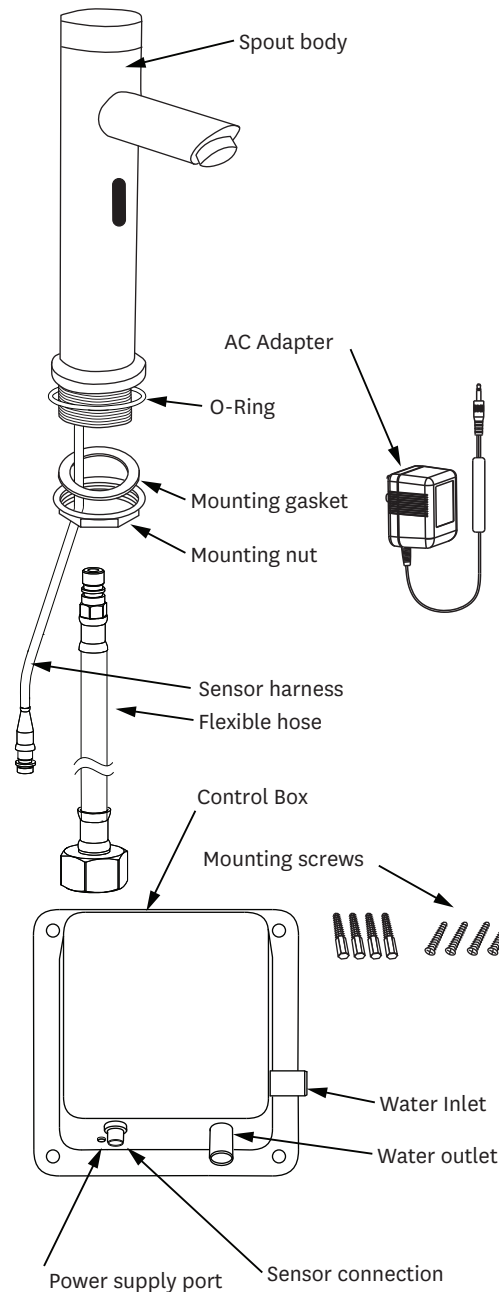

**Care and Cleaning:**

- Never use abrasives or abrasive cleaning agents to clean this product. Clean regularly with contamination free warm soapy water and a damp soft cloth.

**Installation:**

1. Cut a single 35 ± 3mm diameter hole into the mounting surface.
2. Unscrew the mounting nut and remove the mounting gasket.
3. Insert o-ring into the groove in the bottom of the spout body base and connect hose.
4. Feed the hose and sensor harness through the hole cut in the mounting surface.
5. Slide the mounting gasket and mounting nut onto the threaded shaft under the mounting surface.
6. Position the spout body as desired and tighten in place from under the mounting surface.
7. Open the control box. Remove and open the battery box.
8. Insert 4 x 1.5V AA batteries into the battery box, confirm the correct polarity, re-install the battery box and close the control box.
9. Position the control box, in a dry location, near the spout. Ensure that all connections have easy access and install the control box securely.
10. Connect the sensor harness to the control box, and the flexible hose to the control box outlet.
11. Connect the water supply to the control box inlet and check for leaks.
12. Plug the transformer cable into the control box and the transformer into the 220V AC supply.

Remove the cover tape from the sensor window.

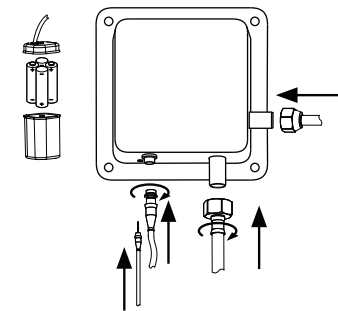
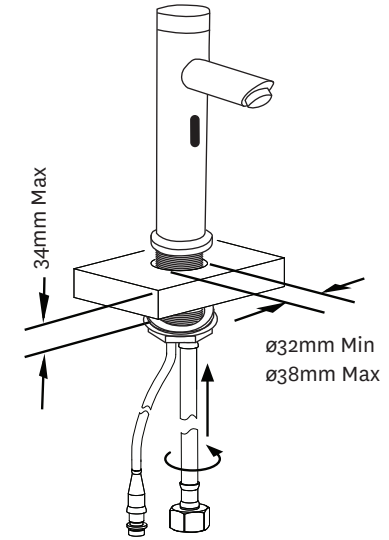

**Do not stretch or twist hose**

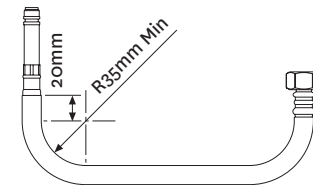
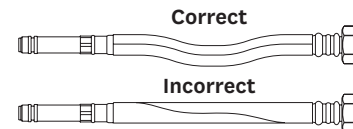

**DO NOT crush  
Hose or swaged  
Ends**