

Push Button Basin Tap

Installation Guide

Technical Specifications:

Operating Pressure:

Min: 150kPa/1.5bar

Max: 600kPa/6bar*

Optimum: 250kPa/2.5bar

Operating Temperature:

Hot: Max 55°C*

Cold: Min 5°C

Recommended: 38°C.

Inlet Connection:

½" BSP male

** Regional specific regulations apply.
Please refer to your warranty statement
at www.methven.com*

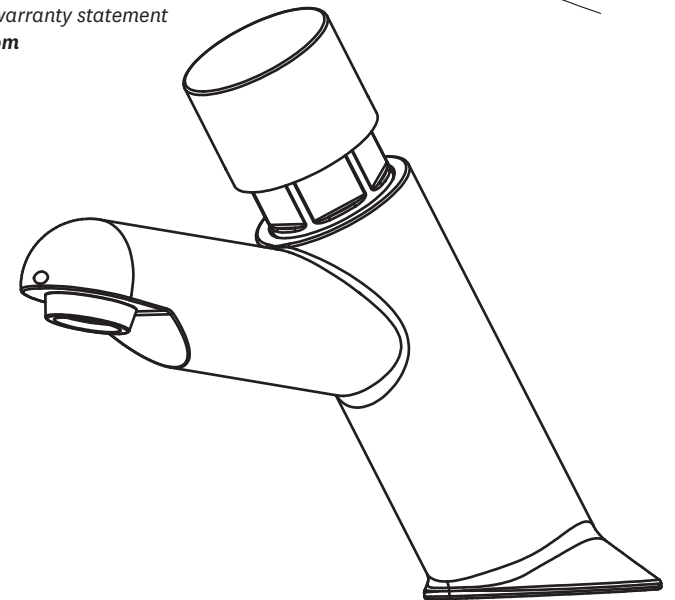

Methven warrants this product against manufacturing defects and that it is suitable for use under the general operating conditions specified in this instruction sheet. However, regional regulations apply and may affect your warranty. Please refer to www.methven.com or call customer service for full details.

New Zealand
0800 804 222

Australia
1300 638 483

UK
0800 195 1602

430004

ISSUE A

METHVEN
www.methven.com

IMPORTANT: Please read all of the instructions before installation.

General:

- Methven recommends this product is installed by a licensed plumber in compliance with all relevant regional regulations.
- Do not hydrostatic test the installation with this mixer installed. Damage to the mechanism may occur.
- All pipe work must be thoroughly flushed prior to the installation of the mixer.
- In-line filters must be installed on the supply to prevent foreign particles damaging the mechanism.
- After installation all connections must be checked for leaks.
- All outlets used primarily for personal hygiene shall deliver water at a safe temperature as per regional regulations.
- This mixer is not recommended for use in uncontrolled heating systems such as wet-backs or solar heating units unless a suitable tempering valve is fitted.
- If limited water flow is experienced, locate aerator and filter washers and clean away foreign material as required.
- It is the responsibility of the installer to ensure a waterproof seal is achieved between the product and mounting surface. If in doubt about the quality of the seal, remove the product and reinstall using silicone to ensure a seal is achieved.

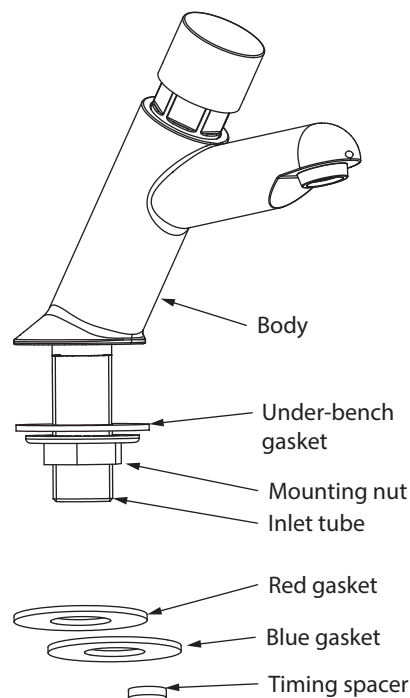

Care and Cleaning:

- Never use abrasives or abrasive cleaning agents to clean this product. Clean regularly with contamination free warm soapy water and a damp soft cloth.

Installation:

1. Cut a hole into the mounting surface, minimum 25mm/maximum 32mm diameter.
2. Unscrew the mounting nut and remove the mounting gaskets.
3. Place the appropriate red or blue gasket onto the threaded inlet tube.
4. Feed the threaded inlet tube through the hole cut in the mounting surface.
5. Place the black mounting gasket and mounting nut onto the threaded inlet tube from under the mounting surface.
6. Position the tap where required and tighten the nut in place from under the mounting surface.
7. Connect the water supply to the threaded inlet tube and check for leaks.

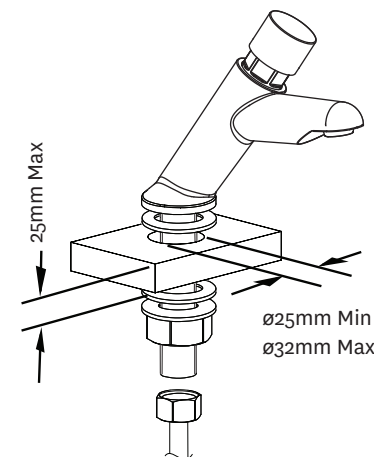

Shut off time adjustment:

- a. If shorter time delay is desired, Turn the water supply off.
- b. Using a flat spanner, carefully unscrew the headworks from the tap body and remove the white reservoir.
- c. Place the timing spacer into the bottom of the reservoir. This will reduce the time delay by approximately 7 seconds.
- d. Replace the reservoir onto the headworks.
- e. Insert the headworks assembly into the tap body, tighten and check for leaks.

