

Flow Rate

The flow restrictor can be changed if the product is going to be used as a bath filler. Spout is supplied with a flow restrictor for basin applications. To change the flow restrictor see instruction below.

Remove flow restricted (pink) aerator using the supplied cache key. Replace with unrestricted (blue) aerator.

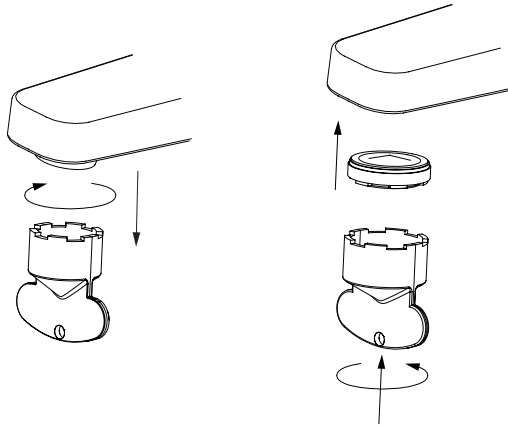

Care and Cleaning:

Never use abrasives or abrasive cleaning agents to clean this product. Clean regularly with contamination free warm soapy water and a damp soft cloth.

Periodically the aerator should be removed as shown below and cleaned under running water.

Methven warrants this product against manufacturing defects and that it is suitable for use under the general operating conditions specified in this instruction sheet. However, regional regulations apply and may affect our warranty. Please refer to www.methven.com or call customer service for full details.

New Zealand
0800 804 222

Australia
13 14 16

UK
0800 195 1602

WAIPORI WALL MOUNTED SINGLE LEVER MIXER INSTALLATION GUIDE

TECHNICAL SPECIFICATIONS

Operating Pressure:

Min 150kPa, Max 1000kPa.

Recommended 150-500kPa.

Recommended installation of a pressure limiting valve if supply exceeds 500kPa.

Operating Temperature:

Hot: Min 55°C (at mixer), Max 80°C.

Cold: Min 5°C.

AS/NZS 3500 requires all hot water supplies to any sanitary fitting to be tempered to 50°C

Inlet Connections:

All ½" BSP.

This product complies with the Lead Free requirements of the National Construction Code Volume Three.



IMPORTANT

Please read all of the instructions before installation

Avoid restrictive piping, fittings or sharp angled bends when plumbing the mixer.

Do not hydrostatic test the installation with this mixer installed. Damage to the ceramic headworks may occur.

All pipe-work must be thoroughly flushed prior to installation of the mixer. In-line filters must be installed on both hot and cold supplies to prevent foreign particles damaging the ceramic headworks.

IMPORTANT:

It is the responsibility of the installer to ensure a waterproof seal is achieved between the product and mounting surface.

It is critical to ensure that a tap is properly sealed to the work surface to prevent leaks and water damage. Failure to do so can result in water leakage, potential damage to the work surface and other related issues. It is recommended to follow the manufacturer's instructions and use an appropriate sealant to ensure a watertight seal between the tap and the work surface. If you are unsure about the installation process, it is advisable to seek professional assistance to avoid any potential issues.

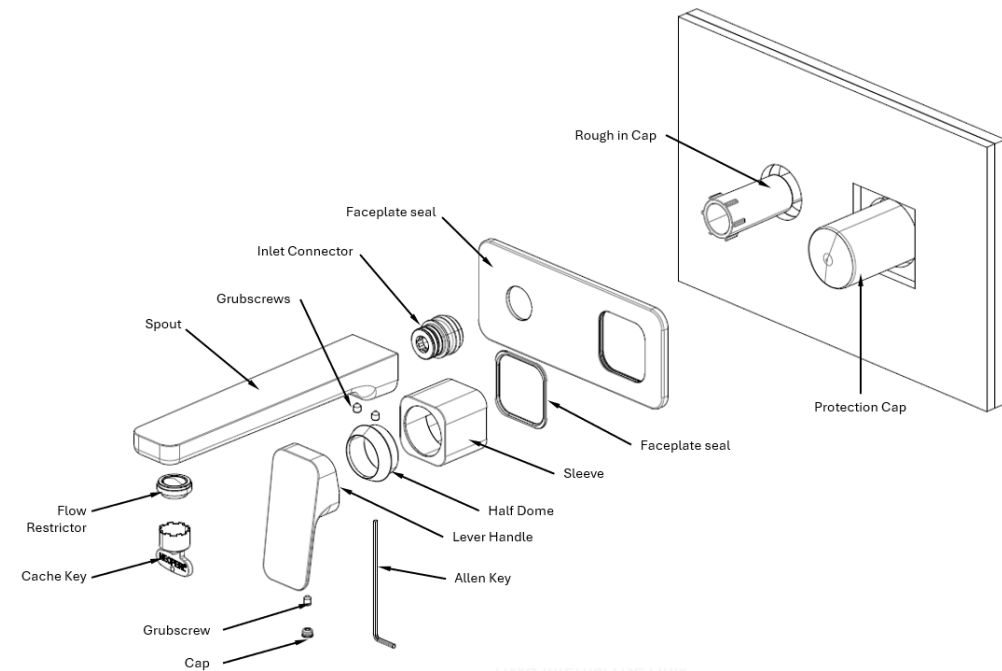

Installation

- Remove protection cap & rough in cap from the mixer body and make sure the external surface of the mixer body is clean.
- Apply lubricant to the o-ring on the mixer body, then slide the sleeve over the mixer body up to the shoulder, ensure the watermark is on the underneath.
- Screw half dome onto the sleeve and hand tighten to secure the sleeve.
- Remove the rough in cap and discard.
- Carefully slide the faceplate including the faceplate seal over the mixer body sleeve and threaded nipple. TIP: wet faceplate seal before fitting over the sleeve.
- Press the faceplate firmly against the wall/tiled face, check that the threaded is the correct length as shown. Cut to length if required ensuring end face is square, see image below. Apply thread tape to the thread.
- **IMPORTANT:** Care must be taken that thread tape cannot become dislodged and block the flow regulating device causing a reduction in water flow. To ensure correct installation, length of exposed thread must not exceed 8mm.
- Screw the Inlet Connector onto the the threaded nipple, using a 10mm Allen Key until the faceplate is held securely to the wall / tile face. DO NOT OVERTIGHTEN.
- Apply suitable lubricant to the O-rings on the Inlet Connector.
- Fit Lever Handle taking that it is pushed fully onto the cartridge stem, then tighten the grubscrew using the 2.5mm Allen Key. Fit Cap taking care not to damage the decorative finish.
- Carefully slide the Spout onto the Inlet Connector until the back of the Spout until it butts up to the Faceplate making sure the top face of the Spout is horizontal. Tighten the Grubscrews using the 2.5mm allen Key. DO NOT OVERTIGHTEN.
- Turn on the Hot and Cold water supply and check mixer operation.

