

Equal High Pressure (Mains) Installation:

Install mixer as supplied

Unequal Pressure and Equal Low Pressure Installation*:

Remove flow restricted (Pink) aerator using the RED cache key.
Replace with unrestricted (blue) aerator.

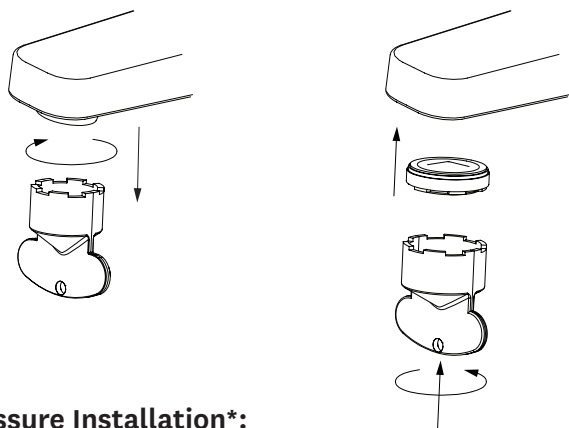

Unequal Pressure Installation*:

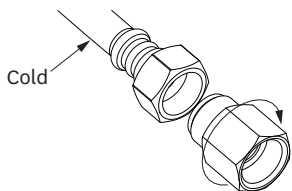

Install the brass nipple into the cold inlet hose.

*Note: Unrestricted aerator and brass nipple not included in some regions.

Care and Cleaning:

Never use abrasives or abrasive cleaning agents to clean this product. Clean regularly with contamination free warm soapy water and a damp soft cloth.

Periodically the aerator should be removed as shown above and cleaned under running water.

Methven warrants this product against manufacturing defects and that it is suitable for use under the general operating conditions specified in this instruction sheet. However, regional regulations apply and may affect your warranty. Please refer to www.methven.com or call customer service for full details.

New Zealand
0800 804 222

Australia
13 14 16

UK
0800 195 1602

IS2059

ISSUE A

WAIPORI BASIN MIXER

Installation Guide

Technical Specifications:

Operating Pressure:

Min 35kPa, Max 1000kPa. Recommended
35kPa - 500kPa. Recommended
installation of a pressure limiting
valve if supply exceeds 500kPa.

Operating Temperature:

Hot: Max 70°C*
Cold: Min 5°C

AS/NZS 3500 requires all hot water
supplies to any sanitary fitting to be
tempered to 50°C

Inlet Connections:

All ½" BSP

This product complies with the Lead Free
requirements of the National
Construction Code Volume Three.

* Regional specific regulations apply.
Please refer to your warranty statement
at www.methven.com



METHVEN
www.methven.com

IMPORTANT: Please read all of the instructions before installation.

General:

- 1) Methven recommends this product is installed by a licensed plumber in compliance with all relevant regional regulations.
- 2) Do not hydrostatic test the installation with this mixer installed. Damage to the ceramic cartridge may occur.
- 3) All pipe work must be thoroughly flushed prior to the installation of the mixer.
- 4) In-line filters must be fitted on both hot and cold supplies to prevent foreign particles damaging the ceramic cartridge.
- 5) Do not remove the ceramic cartridge from the mixer when installing.
- 6) After installation all connections must be checked for leaks.
- 7) All outlets used primarily for personal hygiene shall deliver water at a safe temperature as per regional regulations.
- 8) This mixer is not recommended for use in uncontrolled heating systems such as wet-backs or solar heating units unless a suitable tempering valve is fitted.
- 9) If limited water flow is experienced, locate aerator and filter washers and clean away foreign material as required.

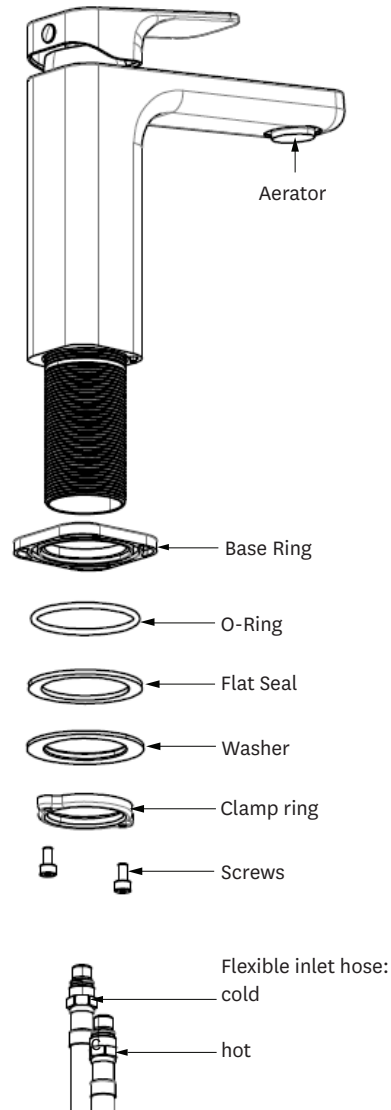

Installation:

1. Cut a single hole minimum 34mm/ maximum 36mm diameter into the mounting surface.
2. Connect both flexible hoses to the mixer. Insert o-ring into the groove in the bottom of the base ring.
3. Feed the mixer hoses and Tap through the hole
4. Fit washer together with flat seal over threaded tube of tap as shown. Screw clamp ring onto threaded tube until it contacts washer & the flat seal has contacted the underside of the deck. Tighten two screws using a 3mm allen key until mixer assembly is clamped firmly to the deck.
DO NOT OVERTIGHTEN.
5. Connect the flexible hoses to the hot and cold supplies (hot on the left, cold on the right).

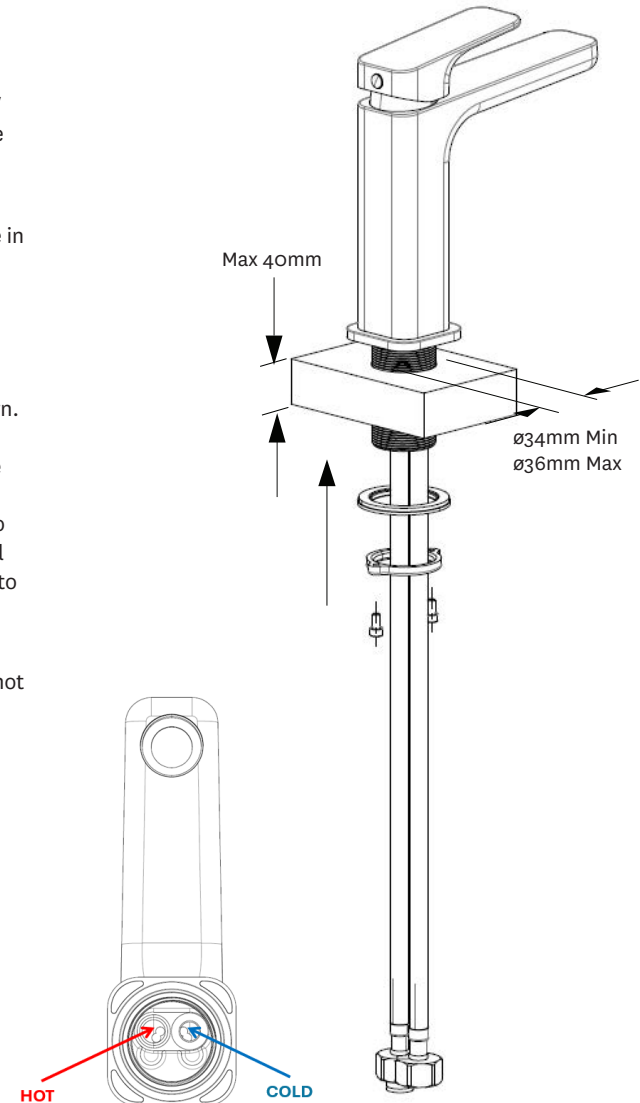

IMPORTANT:

It is the responsibility of the installer to ensure a waterproof seal is achieved between the product and mounting surface. It is crucial to ensure that a tap is properly sealed to a work surface to prevent leaks and water damage. Failure to do so can result in water leakage, potential damage to the work surface, and other related issues. It is recommended to follow the manufacturer's instructions and use an appropriate sealant to ensure a secure and watertight seal between the tap and the work surface. If you are unsure about the installation process, it is advisable to seek professional assistance to avoid any potential issues.

