

# ROUND WET/DRY RAIL

## Installation Guide

### Technical Specifications:

#### Inlet Connections:

All 1/2" BSP

*\* Regional specific regulations apply.*

*Please refer to your warranty statement at [www.methven.com](http://www.methven.com)*

### Step 4

- Fix the bottom rail connector to the wall at the desired position using the mounting screw provided. Check the top and bottom connectors are vertically aligned.

**Maximum centre distance between the connectors is 650mm.**



### Step 5

- Screw the top end of the rail (with o-ring) into the top rail bracket.
- Check the grub screws in the rail brackets are wound out.
- Match the rail brackets to the connectors and push rail into place.
- Tighten grub screws top and bottom.

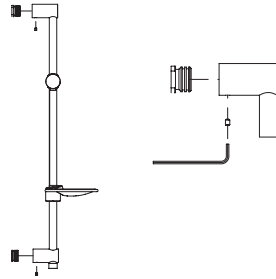

### Step 6

- Connect one end of the hose to the bottom of the rail or the elbow.
- Screw the other end of the hose to the shower handset.
- Ensure there is a washer in both ends of the hose.

### Care and Cleaning:

Never use abrasives or abrasive cleaning agents to clean this product. Clean regularly with contamination free warm soapy water and a damp soft cloth.

Periodically the filter washer should be removed from the end of the shower hose and cleaned.

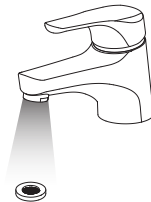

Methven warrants this product against manufacturing defects and that it is suitable for use under the general operating conditions specified in this instruction sheet. However, regional regulations apply and may affect your warranty. Please refer to [www.methven.com](http://www.methven.com) or call customer service for full details.

New Zealand  
0800 804 222

Australia  
1300 638 483

UK  
0800 195 1602

439982

ISSUE B

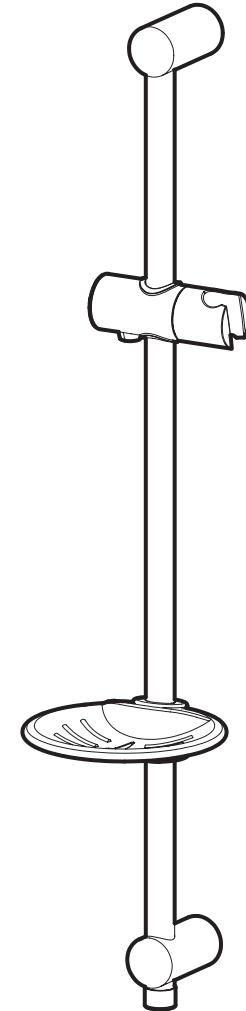

**METHVEN**  
[www.methven.com](http://www.methven.com)

**IMPORTANT:** Please read all of the instructions before installation.

**General:**

- This product must be installed in compliance with all relevant regional regulations.
- It is the responsibility of the installer to ensure a waterproof seal is achieved between the product and mounting surface. If in doubt about the quality of the seal, remove the product and reinstall using silicone to ensure a seal is achieved.
- All pipe work must be thoroughly flushed prior to the installation of the hose.
- After installation all connections must be checked for leaks.
- All outlets used primarily for personal hygiene shall deliver water at a safe temperature as per regional regulations.

**Wet Rail Installation**

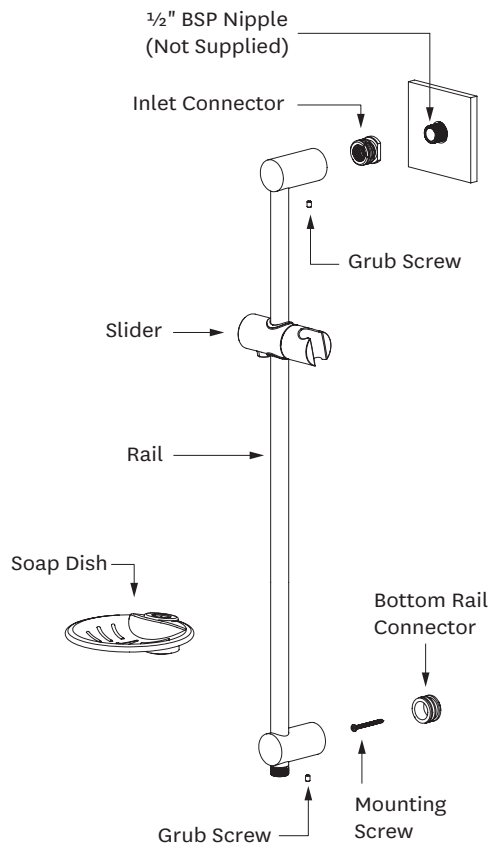

**Dry Rail Installation**

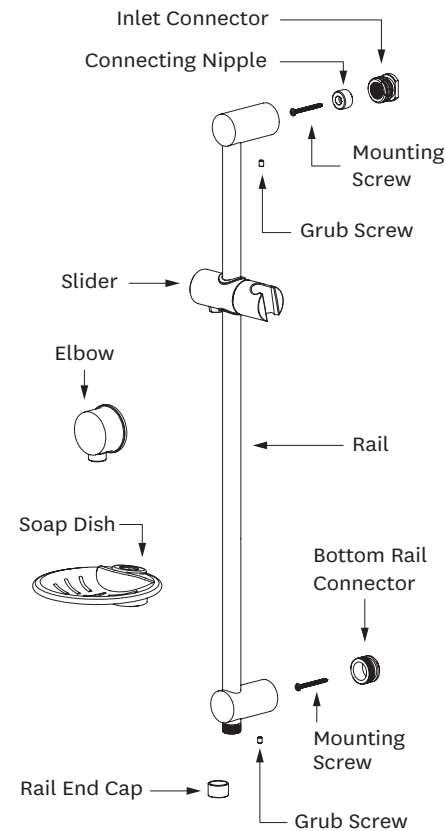

**Installation:**

**Wet Rail**

**Step 1**

- Install 1/2" BSP nipple at the desired **top bracket** position.
- Wall lining hole should be cut or finished as per the dimension shown in the diagram on the right.
- Cut off the threaded nipple 13±2mm from the wall lining and apply thread seal tape to ensure a good seal.

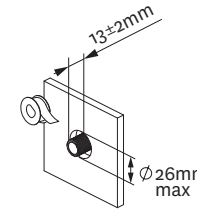

**Step 2**

- Screw the inlet connector onto the nipple.

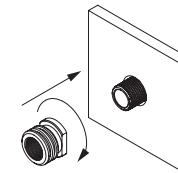

**Step 3**

- Slide the soap dish and bottom rail bracket onto the rail. Check the grub screw is located on the bottom side of the rail bracket.

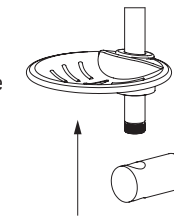

**Dry Rail**

**Step 1**

- Fix the connecting nipple to the wall at the desired top bracket position using the mounting screw provided.
- Screw the inlet connector onto the nipple.

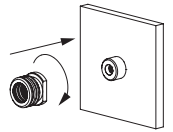

**Step 2**

- Slide the soap dish and bottom rail bracket onto the rail. Check the grub screw is located on the bottom side of the rail bracket.
- Ensure that the washer is in the rail end cap and screw it to the bottom of the rail.

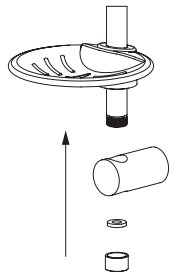

**Step 3**

- Install 1/2" BSP nipple at the desired **elbow** position.
- Wall lining hole should be cut or finished as per the dimension shown in the diagram on the right.
- Cut off the threaded nipple 13±2mm from the wall lining and apply thread seal tape to ensure a good seal.
- Screw the elbow onto the nipple ensuring that the o-ring is sufficiently compressed to create a watertight seal.

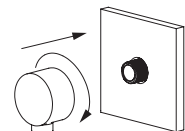
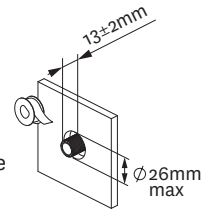

# HANDSET

## Installation Guide

---

### Technical Specifications:

**Operating Pressure:**

Min: 35kPa/0.35bar

Max: 500kPa/5bar\*

Optimum: 150kPa/1.5bar - 500kPa/5bar

**Operating Temperature:**

Hot: Max 70°C\*

Cold: Min 5°C

**Inlet Connections:**

½" BSP



---

**Operating Pressure:**

Min: 150kPa/1.5bar

Max: 500kPa/5bar\*

Optimum: 150kPa/1.5bar - 500kPa

**Operating Temperature:**

Hot: Max 70°C\*

Cold: Min 5°C

**Inlet Connections:**

½" BSP



*\* Regional specific regulations apply.*

*Please refer to your warranty statement at*

**[www.methven.com](http://www.methven.com)**

**IMPORTANT:** Please read all of the instructions before installation.

### **General:**

- Methven recommends this product is installed by a licensed plumber in compliance with all relevant regional regulations.
- After installation all connections must be checked for leaks.
- All outlets used primarily for personal hygiene shall deliver water at a safe temperature as per regional regulations.
- It is the responsibility of the installer to ensure a waterproof seal is achieved.
- NOTE: Some showers may not provide an effective shower when used with gravity fed heated water systems or where pressures are less than 150kPa/1.5bar at the outlet. Additionally showers with flow rates of less than 9L/min may not allow the following to function correctly:
  - some instantaneous water heaters
  - some tempering valves
  - some thermostatic mixing valves

### **Low and Unequal Pressure:**

Removal of the flow restrictor in the handset may be necessary to optimise flow performance in low or unequal pressure systems only.

### **Care and Cleaning:**

Never use abrasives or abrasive cleaning agents to clean this product. Clean regularly with contamination free warm soapy water and a damp soft cloth.

A filter washer should be installed in the hose cone on the water outlet and it should be cleaned periodically.

If shower performance is compromised by the build-up of lime-scale, soak in limescale remover for up to 10 minutes. Do not use products containing chlorine bleach or hydrochloric acid as these can damage the shower. Always rinse the shower thoroughly after cleaning to remove cleaning products that can damage the shower.

---

Methven warrants this product against manufacturing defects and that it is suitable for use under the general operating conditions specified in this instruction sheet. However, regional regulations apply and may affect your warranty. Please refer to [www.methven.com](http://www.methven.com) or call customer service for full details.

New Zealand  
0800 804 222

Australia  
1300 638 483

UK  
0800 195 1602