

## Shower Installation

Refer to diagram at right.

The tools you will need: adjustable spanner

1. Unscrew your old shower anti-clockwise.
2. Clean the exposed thread and bind clockwise with thread sealing tape.
3. Fit the elbow to the wall. Tighten only by hand.
4. Ensure that the elbow is vertical so that the hose hangs straight down.
5. Fit the rail as per instructions at a suitable height and position.
6. Connect the hose and handset using the washers supplied. Hand tighten only.

**NOTE:** Never use abrasives to clean this product. Clean regularly with contamination free warm soapy water or damp soft cloth.

STEP 1

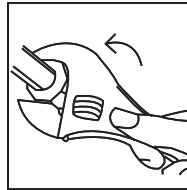

STEP 2

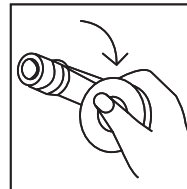

STEP 3

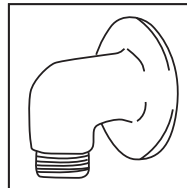

# Rail Shower Set with Apollo Rail and Soap Dish (where provided)

## Installation Guide

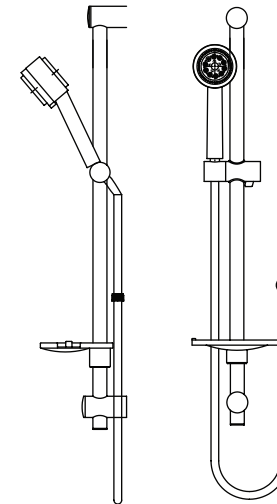

Illustration may not reflect actual product shape.

### HOSE INSTRUCTIONS

## STOP

### DO NOT INSTALL HOSE THIS WAY.

Outer hose will pinch the inner tube and lead to failure.

Such damage is easily recognised and not covered by warranty. Install correctly with a wall elbow (not included).

For commercial, industrial or parahealth use; ask your store consultant for correct shower selection.



## IMPORTANT

Please read all of the instructions before installation

**WELS**

REFER TO  
PRODUCT  
FOR STAR  
RATING

NOV 2009

97-9271

**Methven Australia Pty Ltd**

ABN 15 104 813 390

Melbourne, Australia

[www.methven.com](http://www.methven.com)

[www.methven.com](http://www.methven.com)

## Important Installation Considerations

Please read all of the instructions before installation

1. **NOTE:** Some showers may not provide an effective shower when used with gravity fed heated water systems or where pressures are less than 150kPa at the outlet. Additionally showers with flow rates of less than 9L/min may not allow the following to function correctly:
  - some instantaneous water heaters
  - some tempering valves
  - some thermostatic mixing valves
2. Some shower heads only operate correctly when hot and cold water supplies are both mains pressure and may not be suitable for some instantaneous hot water services.
3. When water pressure is in excess of 500kPa a pressure limiting device is required in accordance with AS/NZS 3500 1.12 recommendation; otherwise hose guarantee will be voided
4. Use of this product in non-domestic applications voids warranty.
5. Damage caused by hydrostatic testing is not covered by our warranty.

## Rail Installation

The tools you will need: screw driver and drill.

Note: This rail has an adjustable bottom pillar and is suitable for the replacement of current rails up to 580mm centres.

1. Establish the desired Rail position and height.
2. Drill the top hole to suit fixing anchor provided.
3. Carefully remove the Rail Pillars' push-in end caps.  
Note: The rail end with the hole is to be located at the top pillar which has a one-sided entry.
4. Locate the top pillar at the desired position.  
Note: If drilling a new hole keep the pillar 25mm down from the top of the rail.
5. Drill the bottom hole to suit fixing anchor provided and screw the bottom pillar in place.
6. Check the handset slider/holder and soap dish (where provided) are on the rail.
7. Slide the rail up through the top pillar.
8. Fit the rail to the bottom pillar and attach to the wall using anchor and screw through the rail.
9. Replace the push-in end caps.
10. Fit the end cap to the top of the rail.

### THE METHVEN GUARANTEE

The warranty statement shall apply to all tapware & showers supplied by Methven  
For more information visit [www.methven.com](http://www.methven.com)

THIS WARRANTY ISSUED BY: Methven Australia Pty Ltd, Melbourne Australia