

Futura Sink Mixer

with adjustable cartridge for temperature and flow control



Important – Please read all of the instructions before installation

This Sink Mixer is designed for Equal and Unequal Pressure systems. It is configured for Mains Pressure installations from manufacture to comply with WELS requirements. Refer instructions below for low pressure configuration.

This mixer is not designed for use in uncontrolled heating systems such as wetbacks or solar units unless a Tempering Valve is fitted.

ALL PIPEWORK MUST BE THOROUGHLY FLUSHED PRIOR TO INSTALLATION OF THE MIXER. AN INLINE FILTER MUST BE FITTED TO PREVENT FOREIGN PARTICLES DAMAGING THE CERAMIC CARTRIDGE.

Technical specifications

Operating Pressure:

Min: 35kPa, Max 1000kPa

Recommended 150 – 500kPa

Recommended installation of a pressure limiting valve if supply pressure exceeds 500kPa

Operating Temperature:

Hot: Max 80°C

Cold: Min 5°C

NB: New Zealand Building Code Clause G12 - Water Supplies specifies all outlets used primarily for personal hygiene shall deliver water at a safe temperature.

Inlet Connections: All ½" BSP

Installation Instructions

Equal Low and Unequal Pressure Installations

Unscrew the ferrule and remove the flow restricted aerator, replace it with the grey flow straightener using the O ring to seal.

Equal High (Mains) Pressure Situations

Install mixer without modification

Installation

A 35mm diameter hole is required in the bench top. The bench top cannot exceed 40mm thick

Screw the mounting studs into the bottom of the sink mixer.

Connect the flexible hoses to the mixer body. The hot hose is marked with red stainless steel braiding. Fit the base ring and the O ring to the base of the sink mixer.

Place the hoses through the bench top.

Fit the mounting gasket and mounting plate and tighten the mounting nuts.

2 rubber washers are provided for the flexible hose connections to the nipples. Machined nipple ends are required to ensure a seal to the flexible hose nuts and the rubber washers.

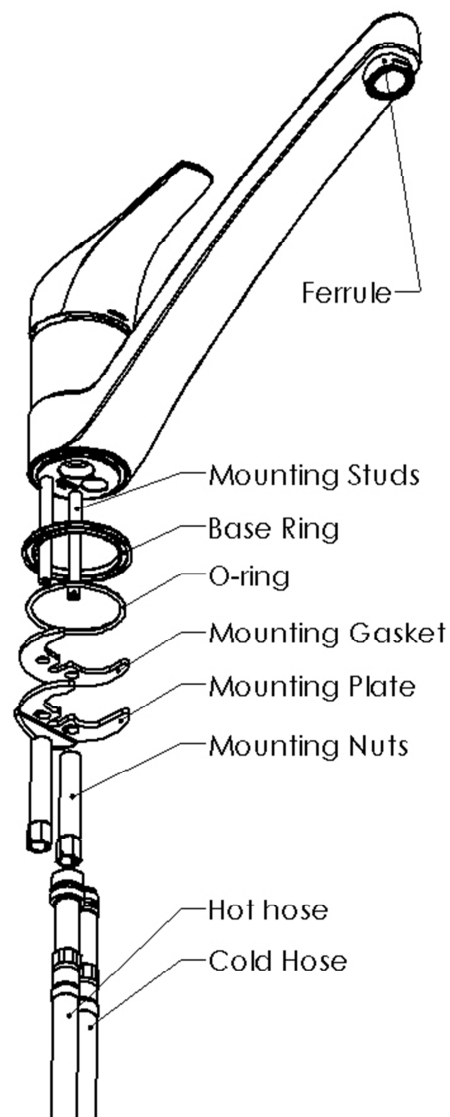

Hose Requirements

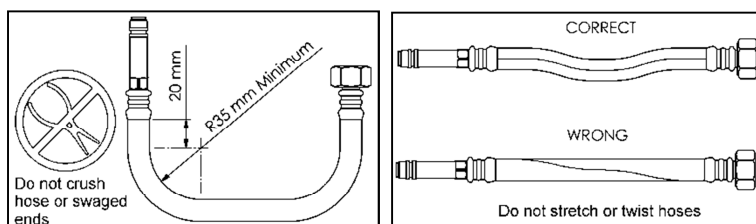

Ceramic Cartridge Adjustment

Do not remove the ceramic cartridge from the mixer while carrying out the following adjustments.

Flow Adjustment

Using a 2.5mm hex key, loosen the grub screw through the hole in the back of the handle.

Pull the handle off the mixer.

Carefully pry the small blue wedge from the back of the cartridge stem.

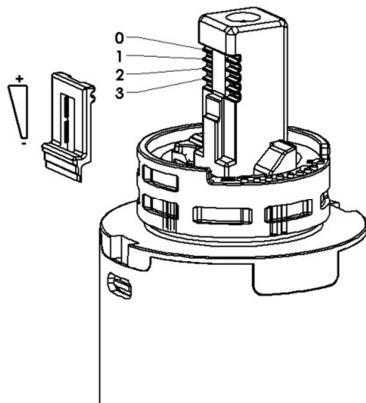

Reinsert it in to a lower groove on the stem ensuring it is fully clicked in. The handle cannot be assembled unless it is inserted correctly.

Reverse instructions to re-assemble.

Temperature Adjustment

Using a 2.5mm hex key, loosen the grub screw through the hole in the back of the handle.

Pull the handle off the mixer.

With a small screw driver carefully pry the red Temperature Limiting Ring from its locator.

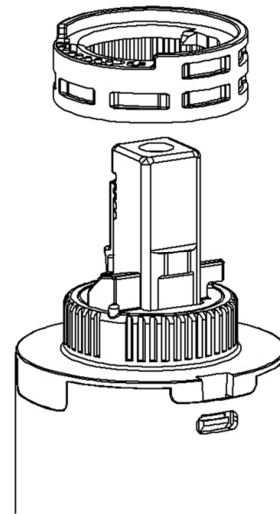

Turn the Temperature limiting ring clockwise (+) to increase maximum hot temperature, anti-clockwise (-) to reduce the maximum hot temperature.

Replace the adjustment ring in the locator and push firmly to secure. The raised portion of the ring with the +/- markings should be to the front of the faucet.

Reverse instructions to re-assemble.

METHVEN LTD

For you warranty please refer to www.methven.com or call Customer Service

New Zealand
0800 804 222

Australia
1 300 638 483

UK
0800 195 1602