

Wall Top Assembly

Kiri

HOT 01-5795

COLD 01-5788

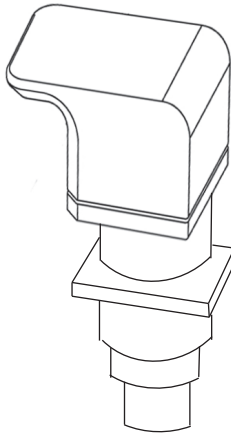

Illustration may not reflect actual product shape.

Installation Guide

IMPORTANT

Please read all of the instructions before installation

Use of this product in non-domestic applications voids warranty.
All pipe work must be thoroughly flushed prior to the installation of the mixer.
NEFA inline filters must be installed on both hot and cold supplies.
Do not remove the ceramic cartridge from the mixer when installing.
Damage caused by hydrostatic testing is not covered by our warranty.



Technical Specifications

Inlet Connections:	All 1/2" BSP
Operating Pressure:	150kPa - 500kPa
Operating Temperatures:	Recommended hot water supply 50°C, maximum 70°C. AS 3500 requires all hot water supplies to any sanitary fitting to be tempered to 50°C.
Recommended Rough in Set up:	Face of finished wall to front of breech (body) 8mm
Tolerance :	Min: 4mm Max: 12mm

SPARE PARTS

Standard Spindle & Handle Assembly Set up



Extended Spindles (Not Included)
Hot 04-9707
Cold 04-9714
Flange Male Adaptor 04-9899

STANDARD WALL-TOP ASSEMBLY

Adjustment For Handle Line Up.

The spindle can be tightened allowing the handle to be adjusted on the spline.

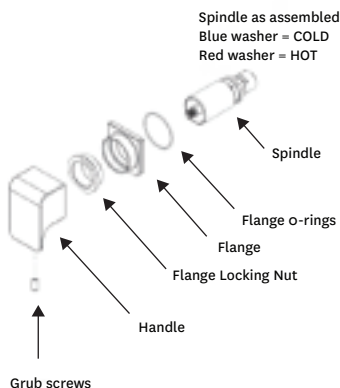

AUG 2010

MA015801

THE METHVEN GUARANTEE

The warranty statement shall apply to all tapware & showers supplied by Methven
For more information visit www.methven.com

THIS WARRANTY ISSUED BY: Methven Australia Pty Ltd, Melbourne Australia

We recommend that this product is installed by a licensed plumber.